

ST-120

MONOGAS
AIRE o N₂

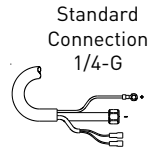
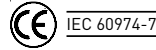
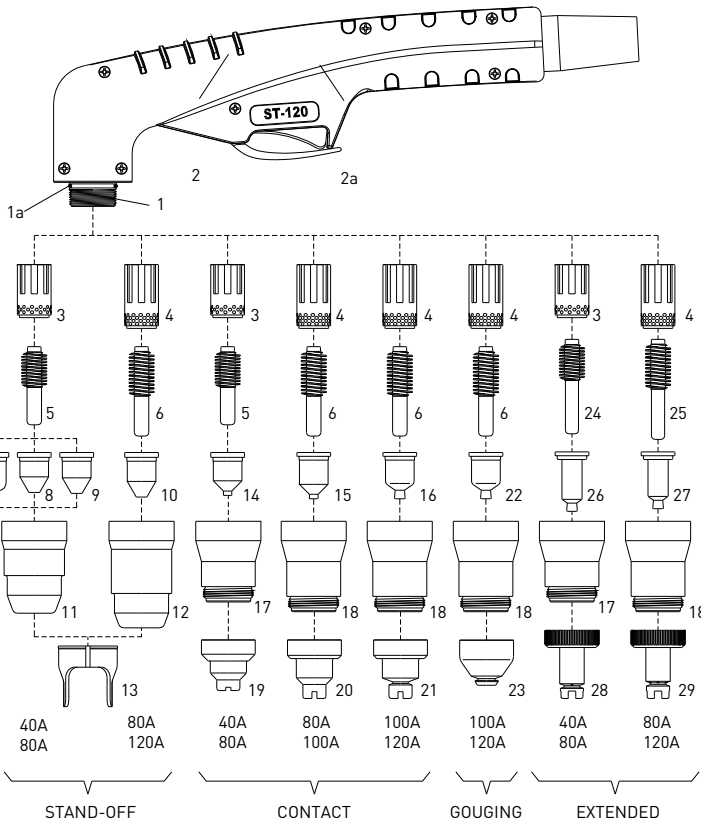

Current	40-120 Amps
Duty Cycle	120 Amps 60%
Gas	Air/N ₂
Gas Pressure	72-87 PSI (5.0-6.0 bar)
Gas Flow	630 SCFH (295 lpm)
Pilot	Electrode to Tip (18-22A)
Ignition	Without HF

Para la operación correcta, utilice:
Válvula solenoide de 3 vías, orificio interior
4.5-5.5mm - (0.178-0.217 inches)

PIEZAS DE REPUESTO

ITEM	REFERENCIA	DESCRIPCIÓN
PIEZAS DE LA ANTORCHA		
1	CS03800	ST-120 Hand Torch Head
1a	CS02800.60	O-Ring
2	CS09705	Handle with Switch
2a	CS07301.20	Switch
3	CS60043E	Swirl ring, 40-80A
	CS60043	Swirl ring, 40-80A Maximum Life
4	CS60044E	Swirl ring, 80-120A
	CS60044	Swirl ring, 80-120A Maximum Life
5	CS52675	Electrode, 40-80A
6	CS52676	Electrode, 80-120A
7	CS51402	Tip, Cutting, 40A
8	CS51403	Tip, Cutting, 60A
9	CS51404	Tip, Cutting, 80A
10	CS51408	Tip, Cutting, 100A
	CS51408T	Tip, Cutting, 120A
11	CS60493	Retaining Cap, 40-80A
12	CS60494	Retaining Cap, 80-120A
13	CS60434	Double Pointed Spacer
14	CS51405.10	Contact Tip, Cutting, 40A
	CS51405.12	Contact Tip, Cutting, 60A
	CS51405.14	Contact Tip, Cutting, 80A
15	CS51406	Contact Tip, Cutting, 100A
16	CS51406T	Contact Tip, Cutting, 120A
17	CS60495	Shield Cup Body, 40-80A
18	CS60496	Shield Cup Body, 80-120A
19	CS51981/TD	Shield Cap, Hand, 40-80A
20	CS51983/TD	Shield Cap, Hand, 80-100A

ITEM	REFERENCIA	DESCRIPCIÓN
PIEZAS DE LA ANTORCHA		
21	CS51988	Shield Cap, Hand, 100-120A
22	CS51409.24	Contact Tip, Gouging, 100-120A
23	CS51989G	Shield Cap, Gouging, 100-120A
24	CS52675L	Extended Electrode, 40-80A
25	CS52676L	Extended Electrode, 80-120A
26	CS51405L.10	Extended Shielded Tip, Cutting, 40A
	CS51405L.12	Extended Shielded Tip, Cutting, 60A
	CS51405L.14	Extended Shielded Tip, Cutting, 80A
27	CS51406L.15	Extended Shielded Tip, Cutting, 100A
	CS51406L.18	Extended Shielded Tip, Cutting, 120A
28	CS60505L	Extended Shield Cap, Hand, 40-80A
29	CS51983L	Extended Shield Cap, Hand, 80-120A

REFERENCIA	DESCRIPCIÓN
ANTORCHAS Y CABLES	
CS03820CX	ST-120 Hand Torch, 6m (20 ft) Leads, Coaxial Cable
CS03825CX	ST-120 Hand Torch, 12m (40 ft) Leads, Coaxial Cable
CS09780CX	ST-120 Lead Assembly, Hand, 6m (20 ft) Length, Coaxial Cable
CS09785CX	ST-120 Lead Assembly, Hand, 12m (40 ft) Length, Coaxial Cable

ITEM	REFERENCIA	DESCRIPCIÓN
ACCESORIOS		
N/S	CS51853	Circle Cutting Attachment

Antorchas con cables de diferentes cubiertas y conector central disponible bajo petición.

