

PT-80

MONOGAS

AIRE o N₂

Current	30-80 Amps
Duty Cycle	80 Amps 60%
Gas	Air/N ₂
Gas Pressure	65-75 psi (4.4-5.0 bar)
Gas Flow	340 scfh (160 lpm)
Pilot	Electrode to Tip (18-22A)
Ignition	Without HF

Para la operación correcta, utilice:
Válvula solenoide de 3 vías, orificio interior
2.7-3.0 mm - (0.106-0.118 inches)

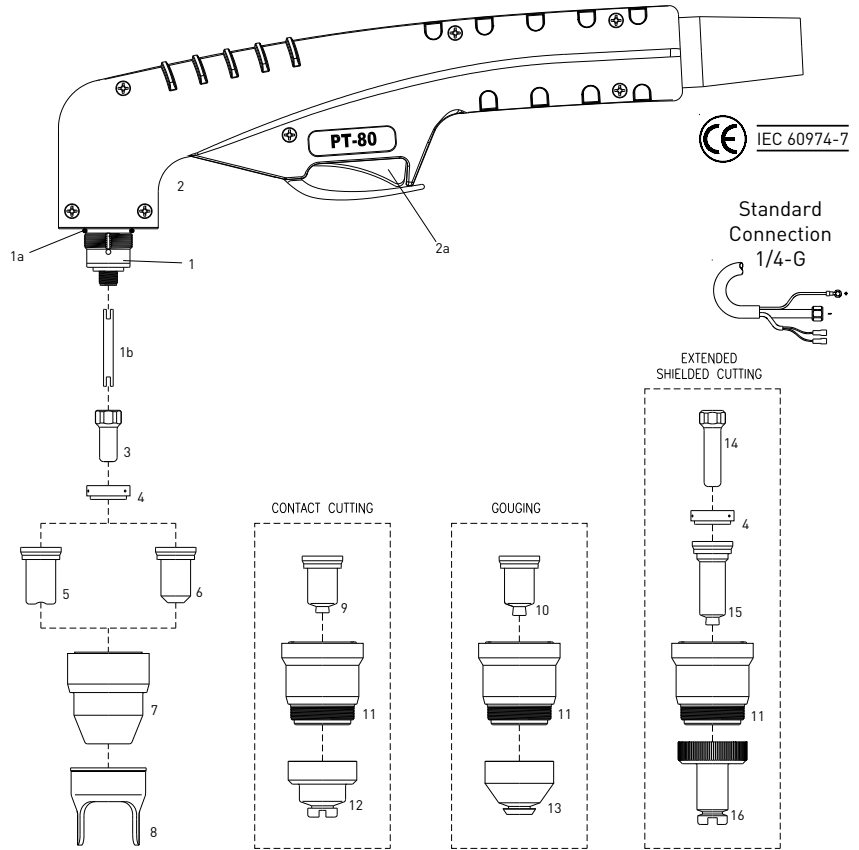
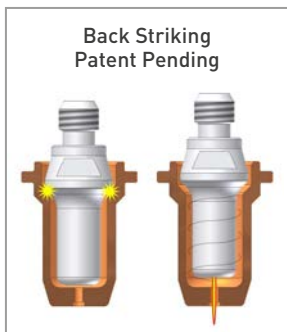

PIEZAS DE REPUESTO

ITEM	REFERENCIA	DESCRIPCIÓN
PIEZAS DE LA ANTORCHA		
1	CS09800	PT-80 Hand Torch Head
1a	CS51620.60	O-Ring
1b	CS09800.42	Cooling Tube
2	CS09705	Handle with Switch
2a	CS07301.20	Switch
3	CS52558	Electrode, Back Striking
4	CS60027	Swirl ring
5	CS51310.09	Tip, Contact Cutting, ø 0.9, 30-40A, Back Striking
6	CS51311.10	Tip, Cutting, ø 1.0, 40-50A, Back Striking
	CS51311.11	Tip, Cutting, ø 1.1, 50-60A, Back Striking
	CS51311.12	Tip, Cutting, ø 1.2, 60-70A, Back Striking
	CS51311.13	Tip, Cutting, ø 1.3, 70-80A, Back Striking
7	CS60510	Retaining Cap
8	CS60434	Double Pointed Spacer (for use with item 6 only)
N/S	CS60368	Wrench for electrode

REFERENCIA	DESCRIPCIÓN
ANTORCHAS Y CABLES	
CS09820CX	PT-80 Hand Torch, 6m (20 ft) Leads, Coaxial Cable
CS09825CX	PT-80 Hand Torch, 12m (40 ft) Leads, Coaxial Cable
CS09780CX	PT-80 Lead Assembly, Hand, 6m (20 ft) Length, Coaxial Cable
CS09785CX	PT-80 Lead Assembly, Hand, 12m (40 ft) Length, Coaxial Cable

ITEM	REFERENCIA	DESCRIPCIÓN
ACCESORIOS		
9	CS51311S.10	Contact Tip, ø 1.0, 40-50A, Back Striking
	CS51311S.11	Contact Tip, ø 1.1, 50-60A, Back Striking
	CS51311S.12	Contact Tip, ø 1.2, 60-70A, Back Striking
	CS51311S.13	Contact Tip, ø 1.3, 70-80A, Back Striking
10	CS51311G.16	Tip, Gouging, 80A, Back Striking
11	CS60511	Shield Cup Body
12	CS60504	Shield Cap, Hand
13	CS60508	Shield Cap, Gouging
14	CS52558L	Extended Electrode
15	CS51311L.10	Extended Shielded Tip, ø 1.0, 40-50A
	CS51311L.11	Extended Shielded Tip, ø 1.1, 50-60A
	CS51311L.12	Extended Shielded Tip, ø 1.2, 60-70A
	CS51311L.13	Extended Shielded Tip, ø 1.3, 70-80A
16	CS60504L	Extended Shield Cap, Hand
N/S	CS51853	Circle Cutting Attachment

Antorchas con cables de diferentes cubiertas y conector central disponible bajo petición.

